

Premier PetTM

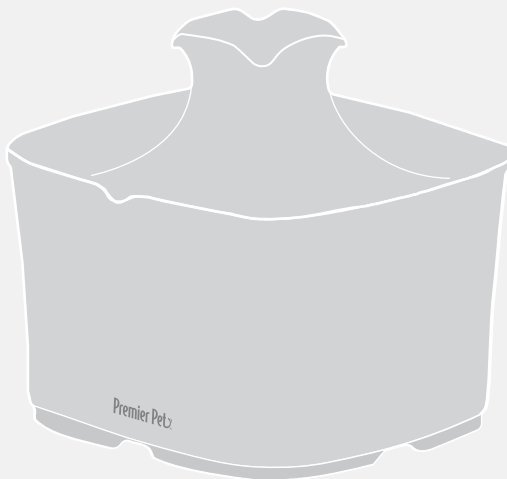

60 oz. Pet Fountain

GW00-17198 | Product Manual



Have questions about your Pet Fountain or need training tips for your pet?

Our Customer Care representatives are here to help you.

Call our USA-based Customer Care Center at

+1 (866) 381-2785

USA & Canada: Mon-Fri 8am-8pm EST | Sat 9am-5pm EST

This product includes a one year warranty.

Call, click or chat with us before you return your product.

premierpet.com

IMPORTANT SAFETY INSTRUCTIONS

Explanation of Attention Words and Symbols used in this Product Manual



This is the safety alert symbol. It is used to alert you to potential personal injury hazards. Obey all safety messages that follow this symbol to avoid possible injury or death.

WARNING

WARNING indicates a hazardous situation which, if not avoided, could result in death or serious injury.

NOTICE

NOTICE is used to address practices not related to personal injury.

WARNING

- When using this product, basic precautions should always be followed including: Read all the instructions before using this product.
- To reduce the risk of injury, close supervision is necessary when using this product near children.
- Do not operate this product with a damaged cord or plug or if the product malfunctions or is dropped or damaged in any manner.
- To reduce the risk of electrical shock, do not place or store product where it can fall or be pulled into a tub or sink while plugged in.
- Always unplug this product when not in use, before assembling or disassembling and before cleaning.
- Dispose of all packaging material properly. Some items may be packed in plastic bags. These bags could cause suffocation. Keep away from children and pets.

NOTICE

- Do not run dry. Always maintain the water level.
- Do not unplug by pulling on the cord. To unplug, grasp the plug, not the cord.
- Do not allow electronics to contact liquids.
- Only rinse the filters with water and never use soap.
- Do not use outdoors. FOR INDOOR USE ONLY.
- Read all instructions before operating product. Save these instructions for future reference.

SAVE THESE INSTRUCTIONS

What's Included

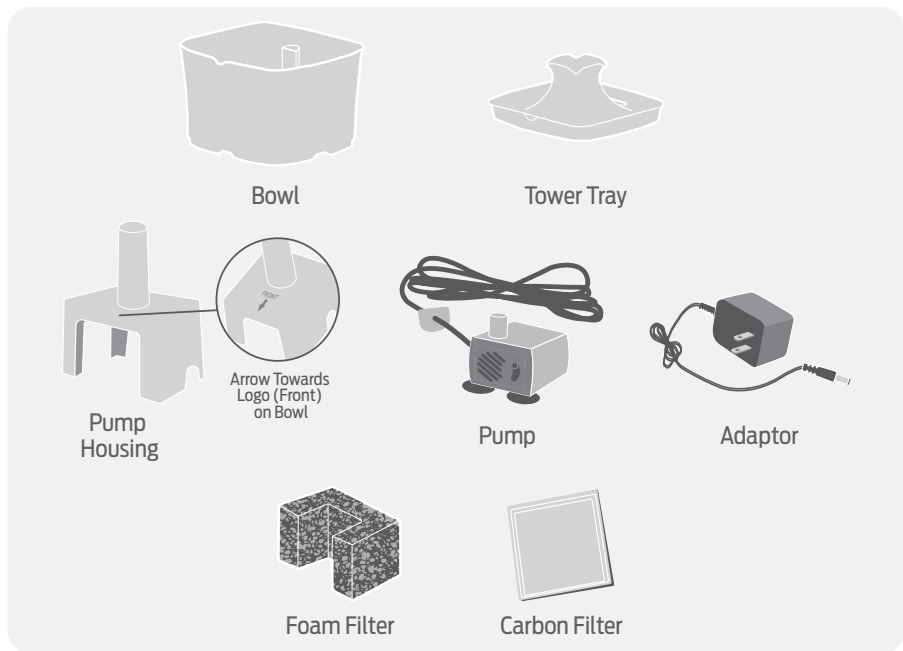

How it Works

The Premier Pet™ 60oz. Pet Fountain holds 60 ounces of fresh, filtered water. Your pet has the option to drink from the free-falling water streams or the shallow tray. The submersible pump is customizable with adjustable flow control and recirculates the water, passing it through 2 filtration systems. The foam filter removes dirt and hair, and the activated carbon filter removes bad tastes and odors. The continuously moving water prevents bacteria growth, keeping the fountain cleaner than a standard water bowl. The BPA-free plastic design comes apart for easy cleaning and is top-shelf dishwasher safe (excluding the pump).

Setup Instructions

1. Rinse all of the fountain components except for the adaptor plug and pump. Disassemble the pump before using. Take the pump apart by first removing the blue faceplate. Use your finger to pull up on the small tab.

2. Remove the blue stator with flow-control knob by pulling up on the small lip. Do not throw this or any other part of the pump away.
3. Use a fingernail to pull out the impeller, which is held in place magnetically. Rinse all of the pump parts before assembling.
4. Reassemble the pump by first inserting the impeller. Then, replace the stator and faceplate. Make sure the flow control knob on the stator is in the correct position for your desired flow rate.
NOTE: If the flow is too strong or spraying any water while it is running, try adjusting the flow to a lower setting.

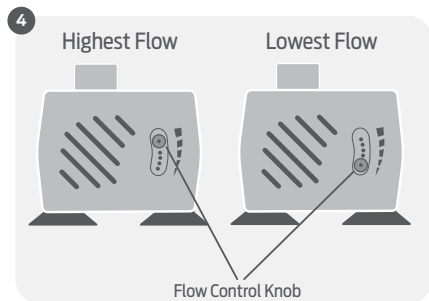
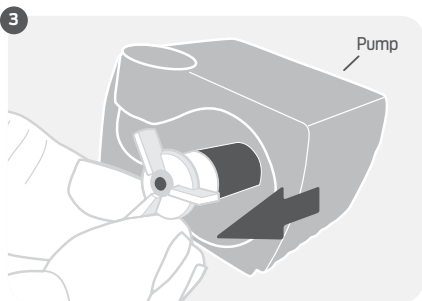
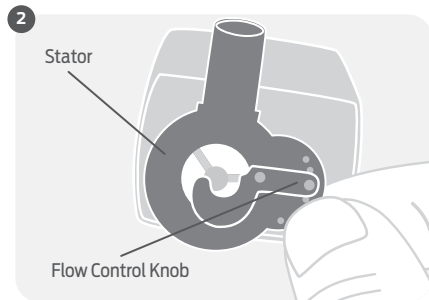
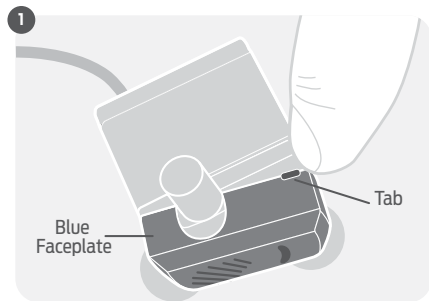

5. Insert the pump into the pump housing. Push it all of the way in.

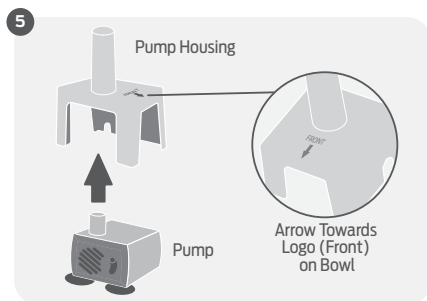

6. Place the foam filter around the pump inside the pump housing with the filter wrapped around the blue faceplate on the pump.

NOTE: The foam filter may be a tight fit inside the pump housing, but that is normal and will help keep the pump in place.

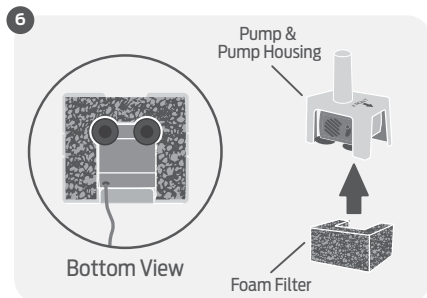

7. Place the pump housing with pump and foam filter in the tabbed area inside the bowl.

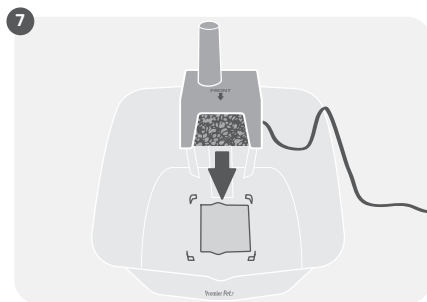

8. Feed the pump cord through the tube in the bowl and press the silicone grommet down into the tube to secure the cord in place.

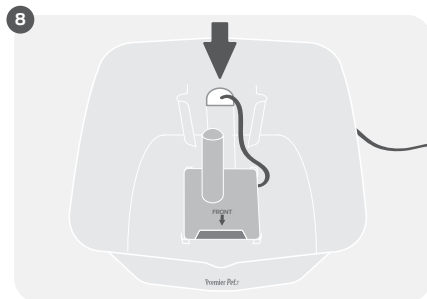

9. Thoroughly rinse the carbon filter and slide it into the slot in the back of the bowl. The filter can go in any direction with either the white or black side facing out.

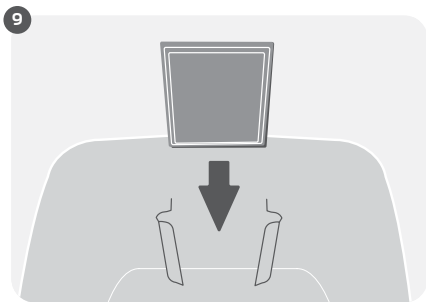

10. Pick the fountain up by the bowl and place it in a desired location. Pour water into the bowl to the "MAX" line. Attach the tower tray to the bowl with the hole in the tray facing the back of the bowl. Push down so that the tray is firmly in place.

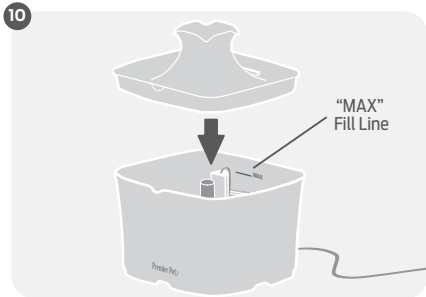

11. Make sure the electrical power cord, the adaptor and your hands are completely dry. Connect the in-line plug and make sure no silver is showing. Then plug the adaptor into a standard electrical wall outlet.

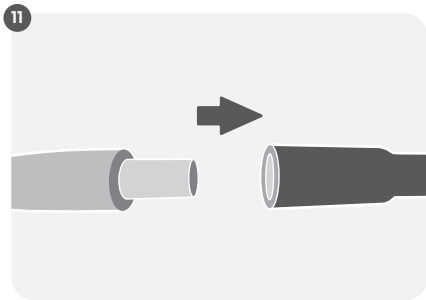

NOTE: Never let the water level fall below 1 inch inside the bowl or your pump might fail.

Cleaning & Maintenance

NOTE: Clean the fountain every 2-4 weeks as needed. Replace the carbon filter every 2-4 weeks and replace the foam filter every 1-2 months.

1. Unplug the fountain from the wall and disconnect the in-line plug from the adaptor.
2. Pick up the pet fountain by the bowl and take it to the sink.
3. Remove the tower tray and discard the carbon filter.
4. To clean the pump, refer to steps 1-4 of the setup instructions. Use a solution of 80% water and 20% white vinegar to remove hard water buildup.
5. Wash all of the other parts with warm water and soap or place them in the top rack of the dishwasher. **NOTE:** Do not place the adaptor or the pump in the dishwasher.
6. Reassemble the pet fountain.

Terms of Use and Limitation of Liability

1. **Terms of Use**

The use of this product is subject to your acceptance without modification of the terms, conditions and notices contained with this product. Use of this product implies acceptance of all such terms, conditions, and notices. If you do not wish to accept these terms, conditions, and notices, please return the product, unused, in its original packaging and at your own cost and risk to the relevant Customer Care location together with proof of purchase for a full refund.

2. **Proper Use**

Proper Use includes, without limitation, reviewing the entire Product Manual and any specific safety information statements. The specific temperament or size/weight of your pet may not be suitable for this product. If you are unsure whether this product is appropriate for your pet, please consult your veterinarian or certified trainer prior to use. For products used with pets where training is desired, Radio Systems Corporation recommends that these training products are not used if your pet is aggressive and accepts no liability for determining suitability in individual cases.

3. **No Unlawful or Prohibited Use**

This product is designed for use with pets only. This product is not intended to harm, injure or provoke. Using this product in a way that is not intended could result in violation of Federal, State or local laws.

4. **Limitation of Liability**

In no event shall Radio Systems Corporation or any of its associated companies be liable for (i) any direct, indirect, punitive, incidental, special or consequential damage and/or (ii) any loss or damages whatsoever arising out of or connected with the use or misuse of this product. The Purchaser assumes all risks and liability from the use of this product to the fullest extent permissible by law.

5. **Modification of Terms and Conditions**

Radio Systems Corporation reserves the right to change the terms, conditions and notices governing this product from time to time. If such changes have been notified to you prior to your use of this product, they shall be binding on you as if incorporated herein.

Warranty

One Year Non-Transferable Limited Warranty

This product has the benefit of a limited manufacturer's warranty. Complete details of the warranty applicable to this product and its terms can be found at www.premierpet.com.

Premier Pet™



Radio Systems Corporation
10427 PetSafe Way
Knoxville, TN 37932
+1 (866) 381-2785
premierpet.com
RE400-2514

©2021 Radio Systems Corporation